

Consumer Center: Atlanta, GA

Curion Consumer Center
Facility Network



The newest addition in our Curion Consumer Center is located in Sandy Springs, expanding Curion's footprint and innovation in the Atlanta metro area for QSR, CPG and durable goods companies. State-of-the-art technology and cutting-edge solutions are available at this location with a full-sized, fully equipped industrial kitchen and client lounge. This location supports a variety of in-facility CLTs and home-use tests methods, including focus groups, Quantitative Descriptive Analysis (QDA®), ethnographies, and claims substantiation.

Appliances

- Commercial Electric Convection Ovens
- 3-Well Deep Commercial Sink
- Four Electric Range Stoves
- 16' Commercial Double-Vent Hood
- Four 50lb Commercial Gas Fryers
- Six 1100w Microwaves
- Electric Commercial Warming Cabinet
- Ice Machine (69 Lb. Production, Undercounter)
- Four Heats Lamps
- Six Electric Griddles
- Flat Top Griddle
- Six Electric Skillets
- Variety Of Small Equipment (Blenders, Coffee Machinery, Scales, Speed Racks, Cooling Racks, Carts, Smallwares)

Storage & Serving Prep

- 3 Storage Rooms, Plus A 12 Ft. Pod Behind The Kitchen
- 8'X7' Walk-In Commercial Refrigerator Unit
- 8'X7' Walk-In Commercial Freezer Unit
- 48 Ft. Of Stainless Steel Adjustable Counterspace (8 6' Tables)

Ammenities & Services

- Commercial Kitchen
- Client Lounge With Viewing Screen
- Client Huddle Room
- Focus Group And Clt Rooms
- Ithut Capabilities
- Client Hospitality And Catering Upon Request
- Prep And Serving Staff
- Ceiling And Wall Mounts For Electricity Ranging From 125v To 240v

Sandy Springs Facility Floor Plan

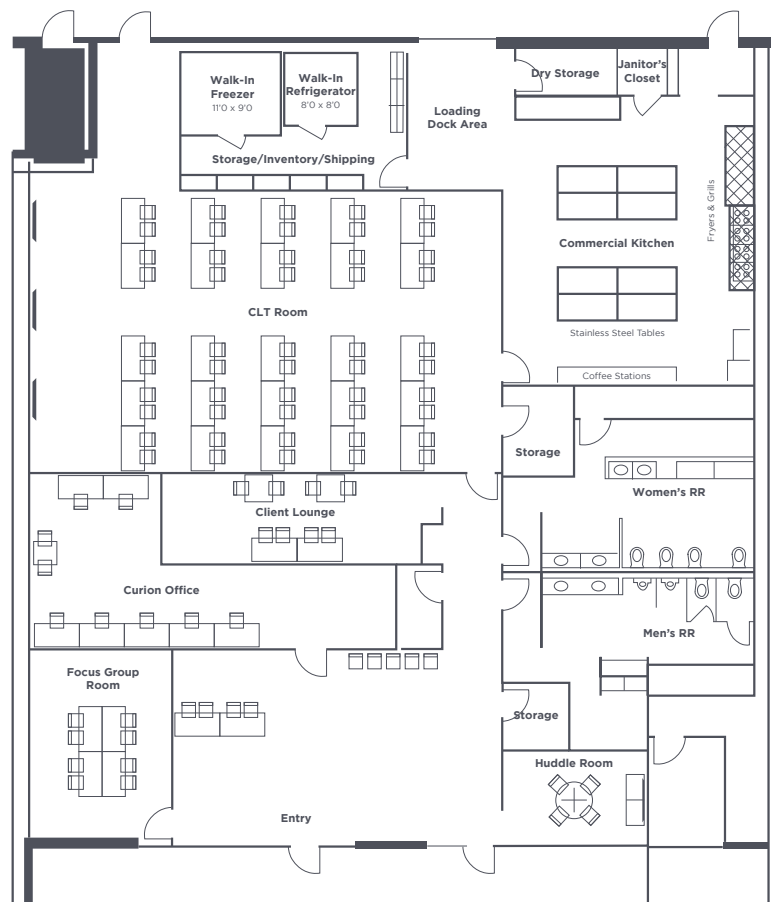

Contact Us: info@curioninsights.com



Recruiting

Proprietary database to easily target, screen and verify desired audiences



Talent

Experienced team working hand in hand on business needs and drive research success



Agility

We own our process internally, allowing for efficiencies and agility when needed



Analytics

Advanced backend analysis and technology workflows pull insights beyond traditional



Modernization

The most technologically advanced, state-of-the-art consumer centers