

# QSR Facility: Atlanta, GA

Curion Consumer Center  
Facility Network



The newest addition in our Curion Consumer Center is located in Sandy Springs, expanding Curion's footprint and innovation in the Atlanta metro area for QSR, CPG and durable goods companies. State-of-the-art technology and cutting-edge solutions are available at this location with a full-sized, fully equipped industrial kitchen and client lounge. This location supports a variety of in-facility CLTs and home-use tests methods, including focus groups, Quantitative Descriptive Analysis (QDA<sup>®</sup>), ethnographies, and claims substantiation.

## Appliances

- Commercial Gas Convection Oven
- 3-well Deep Commercial Sink
- Four Electric Range Stoves
- 16' Commercial Double-vent Hood
- Four 50lb Commercial Gas Fryers
- Six 1100w Microwaves
- Electric Commercial Warming Cabinet
- Four Heats Lamps
- Six Toasters (Allows 24 Slices at Same Time)
- Six Electric Griddles
- Six Electric Skillets
- Variety of Small Equipment (Coffee Machinery, Scales, Speed Racks, Cooling Racks, Carts, Kitchen Supplies and Utensils, Etc.)

## Storage & Serving Prep

- 3 Storage Rooms, Plus a 12 ft. POD Behind the Kitchen
- 8'x7' Walk-in Commercial Refrigerator Unit
- 8'x7' Walk-in Commercial Freezer Unit
- 48 ft. of Stainless Steel Adjustable Counterspace (8 6' Tables)
- 14 ft. of Permanent Cabinets Under Countertops

## Ammenities & Services

- Commercial Kitchen
- Client Lounge with Viewing Screen
- Client Huddle Room
- Focus Group and CLT Rooms
- IHUT Testing Capabilities
- Client Hospitality and Catering Upon Request
- Prep and Serving Staff
- Proctor Leads on Staff

## Sandy Springs QSR Facility

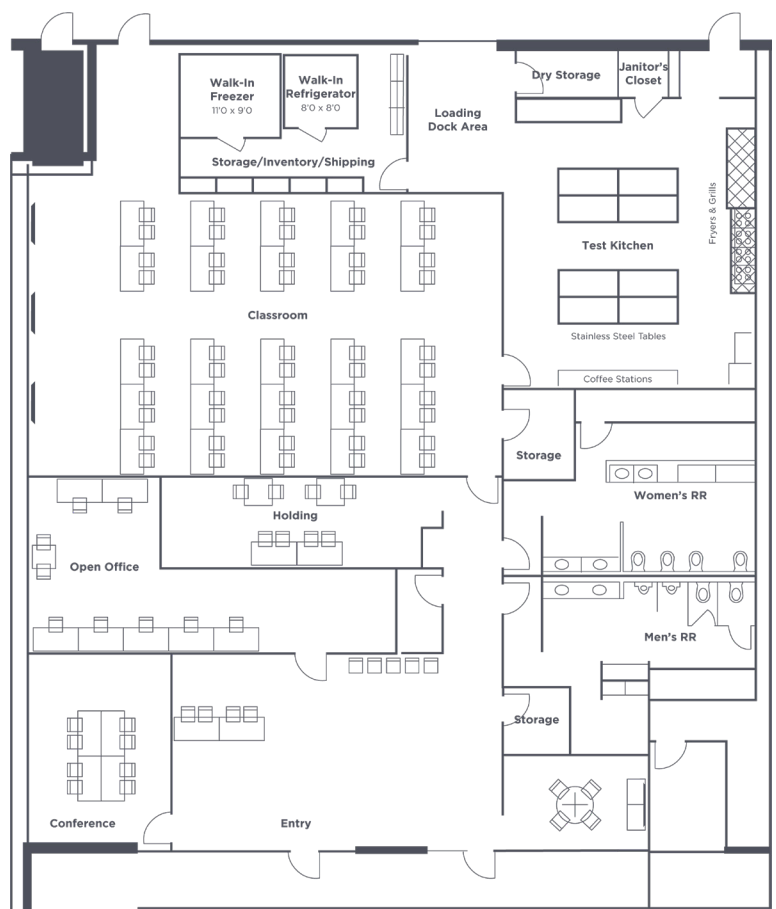

Contact Us: [info@curioninsights.com](mailto:info@curioninsights.com)



## Recruiting

Proprietary database to easily target, screen and verify desired audiences



## Talent

Experienced team working hand in hand on business needs and drive research success



## Agility

We own our process internally, allowing for efficiencies and agility when needed



## Analytics

Advanced backend analysis and technology workflows pull insights beyond traditional



## Modernization

The most technologically advanced, state-of-the-art consumer centers